

CSU MONTEREY BAY INSTITUTIONAL

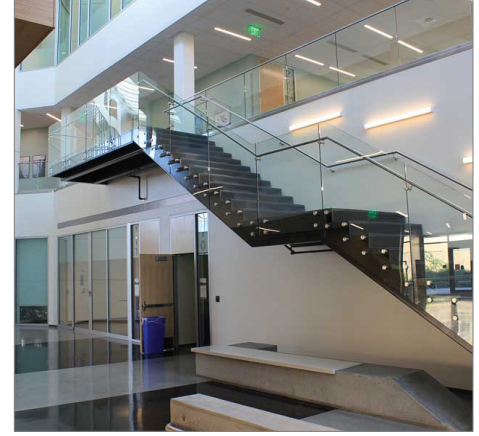

Rendering: CSU Monterey Bay



PROJECT NARRATIVE

This 58,000 ft² building is the new home of the school of Business and Information Technology on the California State University Monterey Bay campus. It was designed to be LEED Gold Certified, with features including natural light in learning and staff areas, on site storm water runoff containment and water conserving plumbing fixtures. Heat-producing direct sunlight is also kept to a minimum with the exterior screen wall.

CONX SOLUTIONS

ConXL's long structural spans were an ideal solution for this structure due to its unique architectural details and building geometry. The ConXL connection is approved by the Division of the State Architect (DSA) for use in California schools.

PROJECT DATA

Square Footage	58,000 ft ²
Steel Assembly Duration	27 Days
Number of Collars	82
Bay Spacing	Varied, 24' to 38'
Structure Weight	476 tons; 16 lbs./ft ²

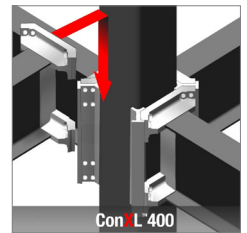

STAKEHOLDERS

Owner	California State University
Architect	HMC Architects
Engineer	Thornton Tomasetti
Contractor	Rudolph & Sletten
Steel Fabricator	ConXtech Manufacturing
Steel Erector	ConXtech Construction
ConXtech Scope	Structural Steel