



550 MORELAND HIGH DENSITY RESIDENTIAL

PROJECT NARRATIVE

Located in Santa Clara, CA, this luxury apartment complex features two 8-story buildings and a rental & recreation building totaling 368,000 ft² built with ConXR 200 over a 2-level subterranean parking podium.

CONX SOLUTIONS

These apartments were originally designed as two 4-story wood buildings over a 1-level subterranean parking podium. The new ConX solution allowed the owner to economically build 8 stories and 200 more units than planned on the same site.

PROJECT DATA

Square Footage	368,000 ft ²
Steel Assembly Duration	74 Days
Number of Collars	1,840
Bay Spacing	12' x 16'
Structure Weight	2,134 tons; 11.6 lbs./ft ²



STAKEHOLDERS

Owner	Prometheus
Architect	KTGY
Engineer	FBA Engineers
Contractor	Palisade Builders
Steel Fabricator	ConXtech Manufacturing
Steel Erector	ConXtech Construction
ConXtech Scope	Structural Steel, Metal Decking, Exterior Panels



CONTACT US

FRAMING PLAN - 550 MORELAND

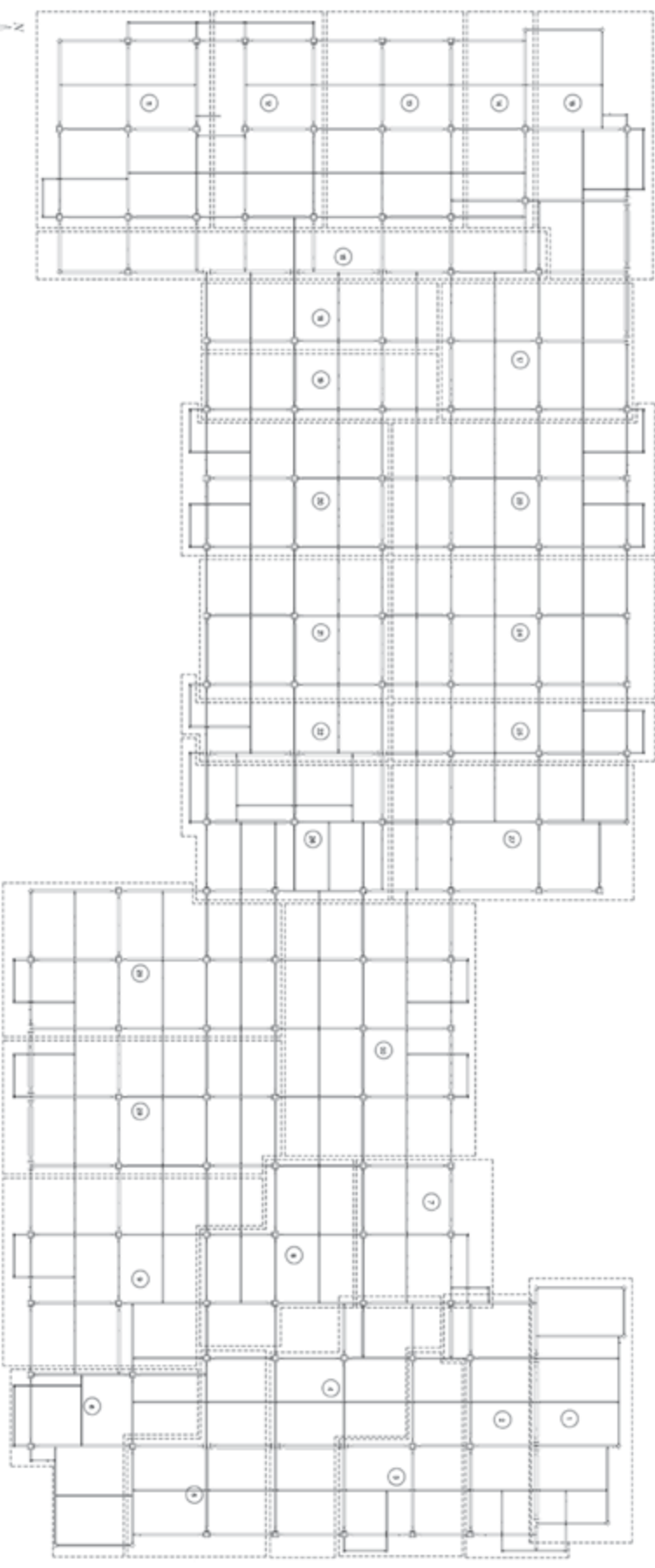

CONTECH REF		DATE	SCALE	DESIGNED BY
ARCH		09/27/09	1/8" = 1'-0"	DELIVERED 1/28/09
PROJECT		550 MORELAND BUILDING 2		
CLIENT		SANTA CLARA, CALIFORNIA		
SHEET		2ND FLOOR FRAMING		
DATE		11/08		
DRAWN BY		EAS		
CHECKED BY		EAS		
APPROVED BY		EAS		
CONTECH		CONTECH		
550 MORELAND BUILDING 2		550 MORELAND BUILDING 2		
SANTA CLARA, CALIFORNIA		SANTA CLARA, CALIFORNIA		
2ND FLOOR FRAMING		2ND FLOOR FRAMING		
DATE		11/08		
DRAWN BY		EAS		
CHECKED BY		EAS		
APPROVED BY		EAS		