

## 8 ORCHIDS HIGH DENSITY RESIDENTIAL

### PROJECT NARRATIVE

This nine-story ConXR structure atop a 3-story concrete podium offers over 200,000 ft<sup>2</sup> of residential space. Common areas include a 20-foot high entry lobby, community room, courtyards and rooftop garden. The rounded building front was designed to accommodate an existing freeway off-ramp and surrounding streets. Street level retail areas complete this innovative building located in historic Chinatown in downtown Oakland, CA.

### CONX SOLUTIONS

The ConXR System was able to easily accommodate the architectural features of this unique, art-deco style building.

### PROJECT DATA

Square Footage	200,000 ft <sup>2</sup>
Steel Assembly Duration	40 Days
Number of Collars	884
Bay Spacing	12' x 16'
Structure Weight	1,200 tons; 12 lbs./ft <sup>2</sup>

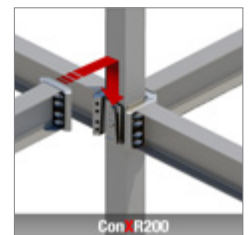

### STAKEHOLDERS

Owner	Bay Rock
Architect	HDO Architects
Engineer	FBA Engineers
Contractor	JR Roberts
Steel Fabricator	ConXtech Manufacturing
Steel Erector	ConXtech Construction
ConXtech Scope	Structural Steel, Metal Decking, Stairs, Exterior Panels



### CONTACT US

# FRAMING PLAN - 8 ORCHIDS

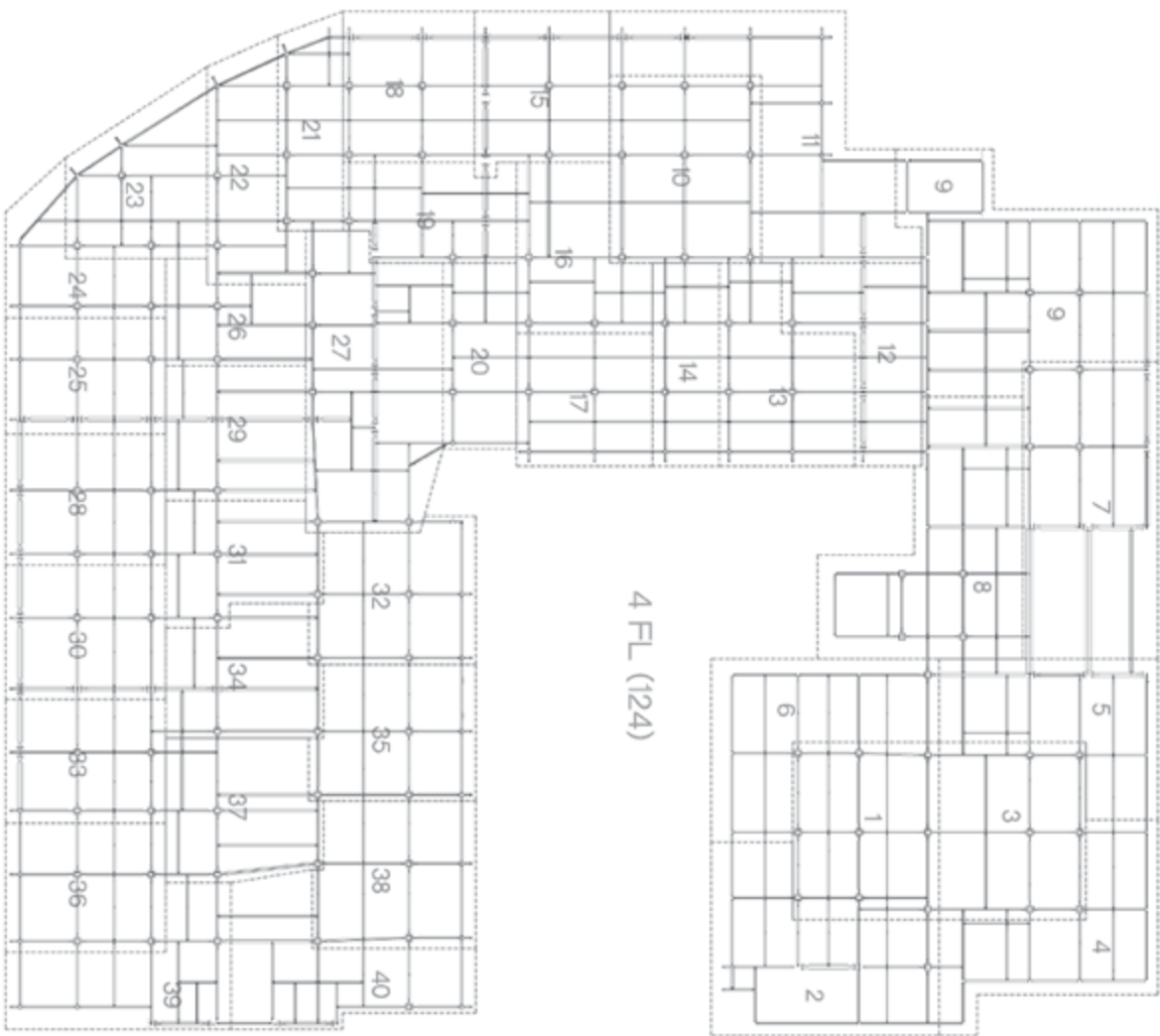

PROJECT NO.		DATE	
DRAWING NO.		SCALE	
<p>  </p>			
<p>                 8 ORCHIDS                  80000 CALIFORNIA                  4TH FLOOR @ TOWER                  124             </p>			
<p>                 ARCHITECT: <b>REDA</b>                  ENGINEER: <b>REDA</b>                  DATE: 08/20/08             </p>			
<p>                 CONXTech                  80000 CALIFORNIA                  4TH FLOOR @ TOWER                  124             </p>			