

ConXtech Just Got Better!

Introducing:



FALCON

Universal Framing Solution

We're excited to unveil our latest breakthrough for the mid-rise structural steel market:

Falcon. Drawing on decades of experience as a builder and as a provider of innovative steel products, this new highly adaptable gravity system redefines structural assembly efficiency and speed. These patented lower + locking gravity connections facilitate steel erection **3-5x faster** than traditional forms of steel erection. On a project greater than 100,000 square feet, **this can mean weeks or months of schedule savings.**

The ConXtech Falcon gravity solution works with any Lateral Force Resisting System, including braced frames, making it an ideal solution for **data centers**, life sciences, and advanced manufacturing facilities.

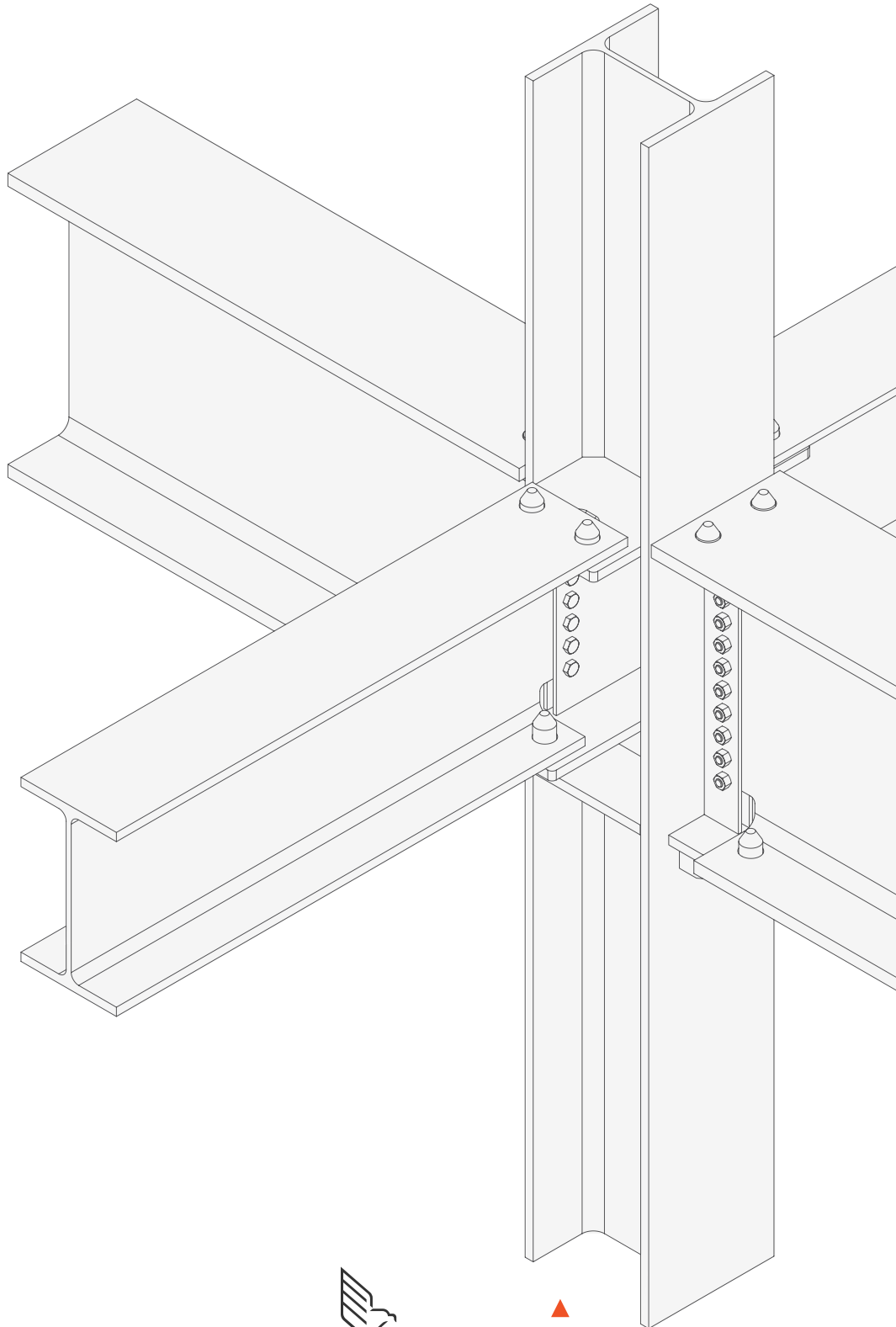

FALCON

Compatible with any LFRS
Universal Erection Stability Connection

*F*lexible

Adopts the SEOR’s design outright, minimizing disruptions to the existing design. A gravity system that can be paired with any LFRS.

*A*ffordable

Uses conventional steel components that are readily available at any mill or service yard. Domestic or international supply chains can be utilized to offer the most cost-effective execution strategy.

*S*calable

Allows for a competitive bidding pool. Any qualified fabricator or erector can build a Falcon design, making every fabricator and erector a partner and not a competitor to ConXtech.

*S*ustainable

Results in an offering that is on par with the conventional steel market from a sustainability standpoint.

*T*ime-Saving

The principle of “Lower & Lock” technology now brings speed of erection and unprecedented safety to the steel erection market for any mid-rise building.

Falcon Advantage

Overview

ConXtech’s legacy moment frame products still offer pronounced advantages where brace-free and flexible program spaces are prioritized. However, with Falcon, ConXtech adopts, rather than replaces, the SEOR’s Lateral Force Resisting System. This enables ConXtech to service any steel mid-rise building, including braced frame buildings, meaning ConXtech is now a solution for a broader range of your projects than ever.

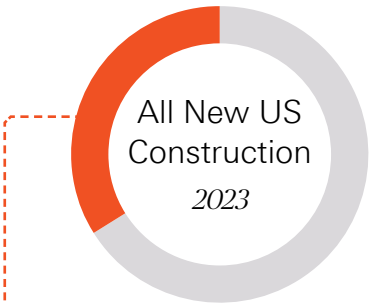

● **\$22.4B**
US Steel Framing Industry (2023)



● **10%**
Special Moment Frame
ConXtech’s bi-axial moment frame solution is perfect for this market given system attributes and cost versus competing solutions.

● **90%**
Braced Frame
ConXtech now offers **Falcon**, a lower + locking gravity system that accelerates project schedules and is compatible with any LFRS (patent pending).

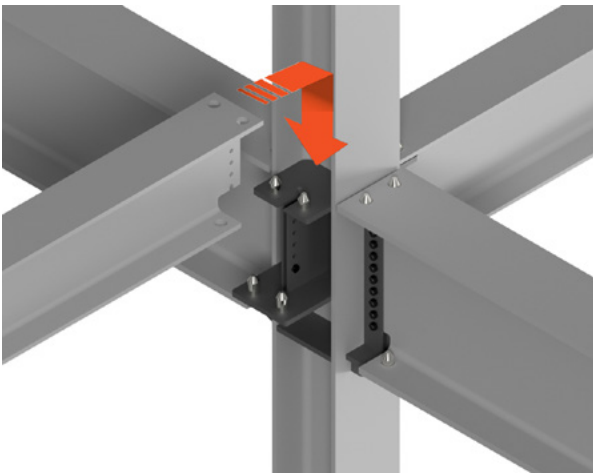

Steel Framing System Comparison

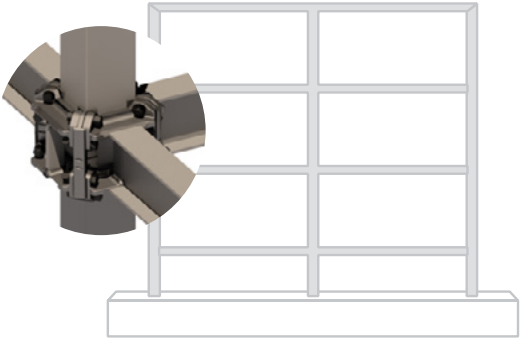

- Moment Frame**
- Open floor plan
 - No sheer walls or bracing
 - Moment frame acts as lateral system

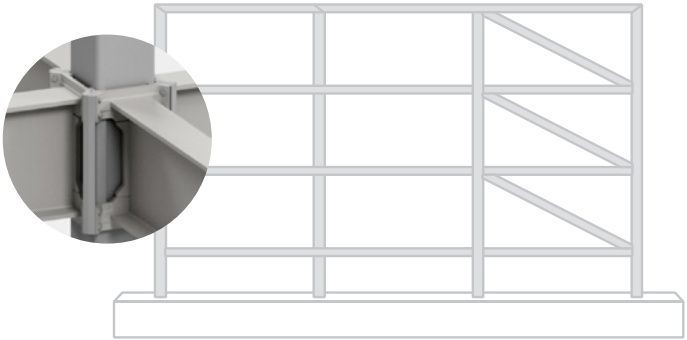

- Braced Frame**
- Lateral force system supported by braces
 - Larger spans and member sizes



For more information on **Falcon**, please contact:

Josh DeLehman
Senior Director, Business Development
(949) 572-8345
jdelehman@conxtech.com

ConXtech Headquarters
6600 Koll Center Parkway, Suite 210
Pleasanton, CA 94566
T (510) 264-9111 F (510) 264-1181
CA Contractor's License NO. 855525

conxtech.com